

# **Welcome to Year 9 Options Evening**

**Monday 13<sup>th</sup> February 2023**



CARDINAL NEWMAN  
CATHOLIC SCHOOL



# Welcome Message

Mrs Scanlon



CARDINAL NEWMAN  
CATHOLIC SCHOOL



# Head boy and girl welcome message



**Brody Houston—**  
**Head Boy**



**Symran Dogra—**  
**Head Girl**



CARDINAL NEWMAN  
CATHOLIC SCHOOL



# Format for the Evening

- Option taking process
- Curriculum Choices
- Options Evening

## Timings for the evening:

5.30pm – 5.50pm: Talk in the canteen

5.50pm – 7pm: Meet with subject staff and discuss choices



CARDINAL NEWMAN  
CATHOLIC SCHOOL



# Option Taking Process

In preparation for their option choices; students have been accessing lots of information to prepare them to make an informed decision.

Options  
launch  
assembly

Subject  
information  
in KS3  
lessons

Options  
information  
booklet

Pastoral  
session to  
support  
choices

New subject  
assembly

Taster  
sessions in  
new  
subjects



CARDINAL NEWMAN  
CATHOLIC SCHOOL



# Option Selection Process

- Students have been sent the options form via email to complete via Microsoft forms
- Deadline for completion is Thursday 16<sup>th</sup> February
- **If students know what they want to select by the end of the evening, then you have a paper copy that can be completed and handed in tonight. The completed forms can be put into the box in the canteen or library.**

Tonight is the opportunity to ask those questions to subject staff so that your child is better informed in their selection of their option subject.

Some questions to think about:

1. How is the course assessed? (e.g. all exams or coursework)
2. What topics are included in the course?
3. Which subjects are you good at?
4. What key skills do you need to have to study the subject?
5. What careers/next steps will the subject lead to?



CARDINAL NEWMAN  
CATHOLIC SCHOOL



# Can you remember your Option choices?

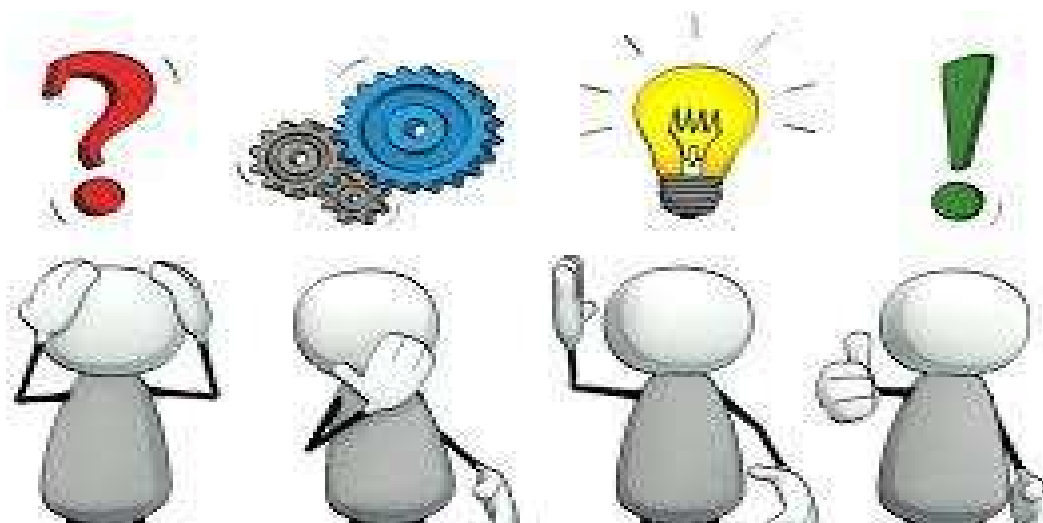

CARDINAL NEWMAN  
CATHOLIC SCHOOL



# Core Curriculum

Some subjects at GCSE are compulsory, so all students have to study them. All students at Cardinal Newman School will study at GCSE:

- English Language & GCSE Literature
- Mathematics
- Science
- Religious Education
- Core Physical Education (non examined)
- PSHE (non examined)



CARDINAL NEWMAN  
CATHOLIC SCHOOL





# Step 1: Students choose either Geography or History



- At Cardinal Newman School students will either select GCSE Geography or History as part of our curriculum model.
- The government recommends that all students choose a humanities subject as part of a broad and balanced curriculum



CARDINAL NEWMAN  
CATHOLIC SCHOOL



# Step 2: Students choose two further options

	Option 1			Option 2	
Language	French			French	
	Spanish			Spanish	
GCSE Subjects	Art			Business	
	Business			Computer Science	
	DT: Food and Nutrition			Media	
	DT: Paper and Boards			Music	
	DT: Timbers			PE/BTEC Sport	
	Drama				
	Photography			ICT	
	Media			Health & Social	
BTEC Subjects	Health & Social				



CARDINAL NEWMAN  
CATHOLIC SCHOOL



**The next thing to consider is which courses are best suited to you:**

**GCSE Courses** – ‘Traditional’ courses which include a mix of theoretical study, investigative and practical work. Courses are usually assessed through written examinations.

**Vocational Courses** (BTEC and Cambridge National) – More vocational in content which develops practical skills and knowledge. Courses are assessed through practical work and the creation of portfolio evidence but also include an exam.



CARDINAL NEWMAN  
CATHOLIC SCHOOL



# The English Baccalaureate Pathway:

- ❖ The EBacc is not a qualification in its own right – it's a combination of GCSE subjects, including a language, that offer an important range of knowledge and skills to young people.
- ❖ Students who take this pathway will study English, Maths, Science, History or Geography and a Language plus one other option.
- ❖ Other languages that qualify for this pathway include:
- ❖ If your child speaks an additional language at home, then there may be an opportunity to complete additional lessons on this outside of the normal school day and complete a GCSE in that language



CARDINAL NEWMAN  
CATHOLIC SCHOOL

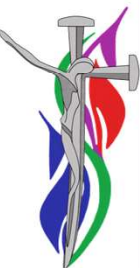

# GCSE Options Form

The form can be completed online and has been emailed out to students via their school email address

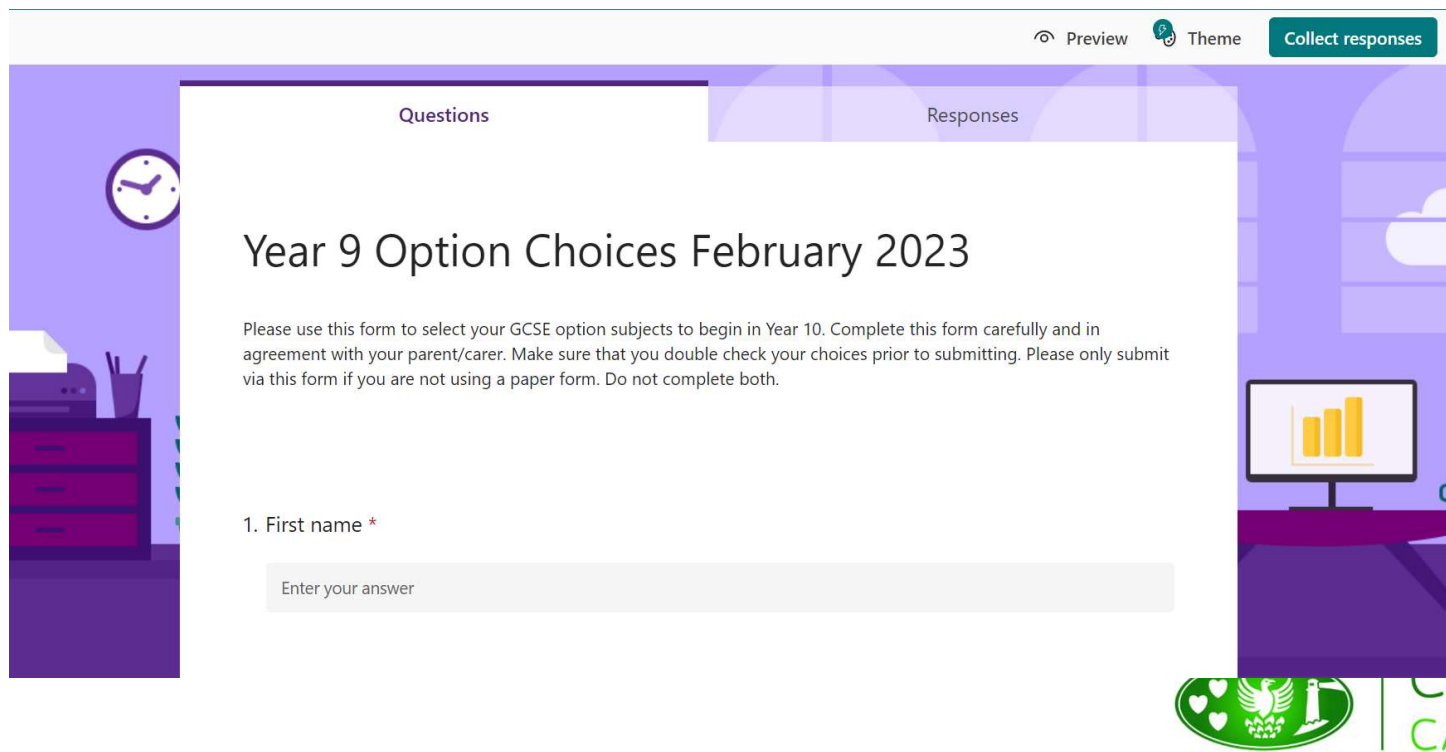

The screenshot shows a web-based form titled "Year 9 Option Choices February 2023". At the top, there are three buttons: "Preview", "Theme", and "Collect responses". Below these, there are two tabs: "Questions" and "Responses". The "Questions" tab is active, showing the form title and instructions. The instructions state: "Please use this form to select your GCSE option subjects to begin in Year 10. Complete this form carefully and in agreement with your parent/carer. Make sure that you double check your choices prior to submitting. Please only submit via this form if you are not using a paper form. Do not complete both." The first question is "1. First name \*", followed by a text input field with the placeholder "Enter your answer". The background of the form interface features a purple and blue color scheme with various icons, including a clock, a desk with a computer monitor, and a bar chart.

Preview Theme Collect responses

Questions Responses

## Year 9 Option Choices February 2023

Please use this form to select your GCSE option subjects to begin in Year 10. Complete this form carefully and in agreement with your parent/carer. Make sure that you double check your choices prior to submitting. Please only submit via this form if you are not using a paper form. Do not complete both.

1. First name \*

Enter your answer

CARDINAL NEWMAN CATHOLIC SCHOOL

# GCSE Options Form

The form can also be completed on paper and handed in tonight, in the box located in the canteen and library

Full Name		Form	
-----------	--	------	--

← Please write your full name and tutor group

## Core Subjects

All Students will study the following GCSEs:

- English, Maths, Science and Religious Studies

☐ **Humanities Subjects** You must choose one of the Humanities subjects below

<b>Humanities option</b>		Geography	History
	Place one tick in this row →		

↙ Tick either History or Geography



CARDINAL NEWMAN  
CATHOLIC SCHOOL

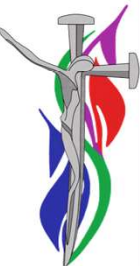

# GCSE Options Form

## Additional Option Choice

Please choose a subject in each column from the choices below. In each column, please choose a first preference and a reserve. Please indicate by placing a "1" for your first preference and a "2" as your reserve. We will always endeavour to allocate first choices but class sizes and viability of courses will affect this.

**Option 1:**  
Please place a 1  
for your first  
choice subject  
and 2 for your  
reserve choice

	Option 1			Option 2	
Language	French			French	1
	Spanish			Spanish	
	Art	1		Business	
	Business			Computer Science	
	DT: Food and Nutrition			Media	
	DT: Paper and Boards			Music	2
	DT: Timbers			PE/BTEC Sport	
	Drama	2			
	Photography			ICT	
	Media			Health & Social	
BTEC Subjects	Health & Social				

**Option 2:**  
Please place a 1  
for your first  
choice subject  
and 2 for your  
reserve choice



CARDINAL NEWMAN  
CATHOLIC SCHOOL





**Do's**

## **Making informed choices – Do's & Don'ts**

- Take time and make a considered decision based on guidance from school and home
- Read the option booklet closely and take every opportunity to speak with teachers and subject leaders
  - Choose subjects you enjoy and are currently successful in
- Look at career and future study pathways and explore how your choices might impact on this
  - Do think carefully about the pathway for you



**Don'ts**

- Don't choose subjects based on friendship groups
- Don't choose a subject because you like the teacher
- Don't think that choosing subject at GCSE plans out your whole future

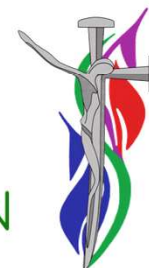

CARDINAL NEWMAN  
CATHOLIC SCHOOL



# What's next....

Heads of department from Core Subject areas are not here this evening, so should you have any questions about English, Maths or RE please contact them by email. Details in the options booklet

Subject staff from all other subjects are here tonight, located in their classrooms. Details of where each of them are located are in the hand out that you received when you signed in.

We also have students as guides, who will take a group at a time to go around the site

## YEAR 9 OPTIONS EVENING SITE MAP

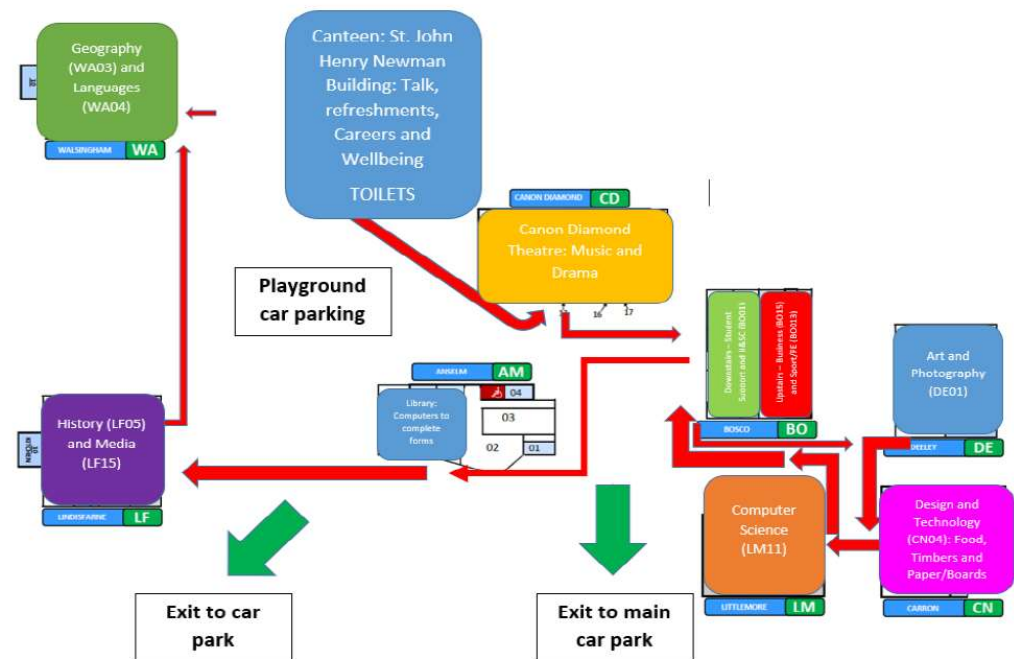

CARDINAL NEWMAN  
CATHOLIC SCHOOL





**We have refreshments available in this room and you can also speak with our careers advisor, plus we have a wellbeing stand**

**The library is open for students to complete their form online and the hand in boxes for paper forms are located in here and the library**

**Deadline for Options form is Thursday 16<sup>th</sup> February**



**CARDINAL NEWMAN  
CATHOLIC SCHOOL**

